

Asbestos Blockplan Willard Building

DO NOT PRINT THESE BLOCKPLANS AND ASSUME CHANGES NEVER OCCUR. UPDATES ARE CONSTANTLY BEING ADDED.

These blockplans DO NOT include the following asbestos containing materials:

Thermal insulations such as pipe, boiler, tank, or duct insulation; these are assumed to contain asbestos unless they are obviously fiberglass or foam rubber.

ALL resilient floorings are also assumed to contain asbestos (i.e. 12"x12" and 9"x9" Floor Tile, Linoleum, etc.).

ALL Soapstone Lab Bench Tops are also assumed to contain asbestos.

Many of these materials are above drop ceilings and are not readily visible. Specific locations of these materials can be obtained by calling Environmental Health and Safety at 5-6391 (3-1111 after 5 P.M.).

Asbestos Blockplan

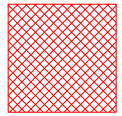
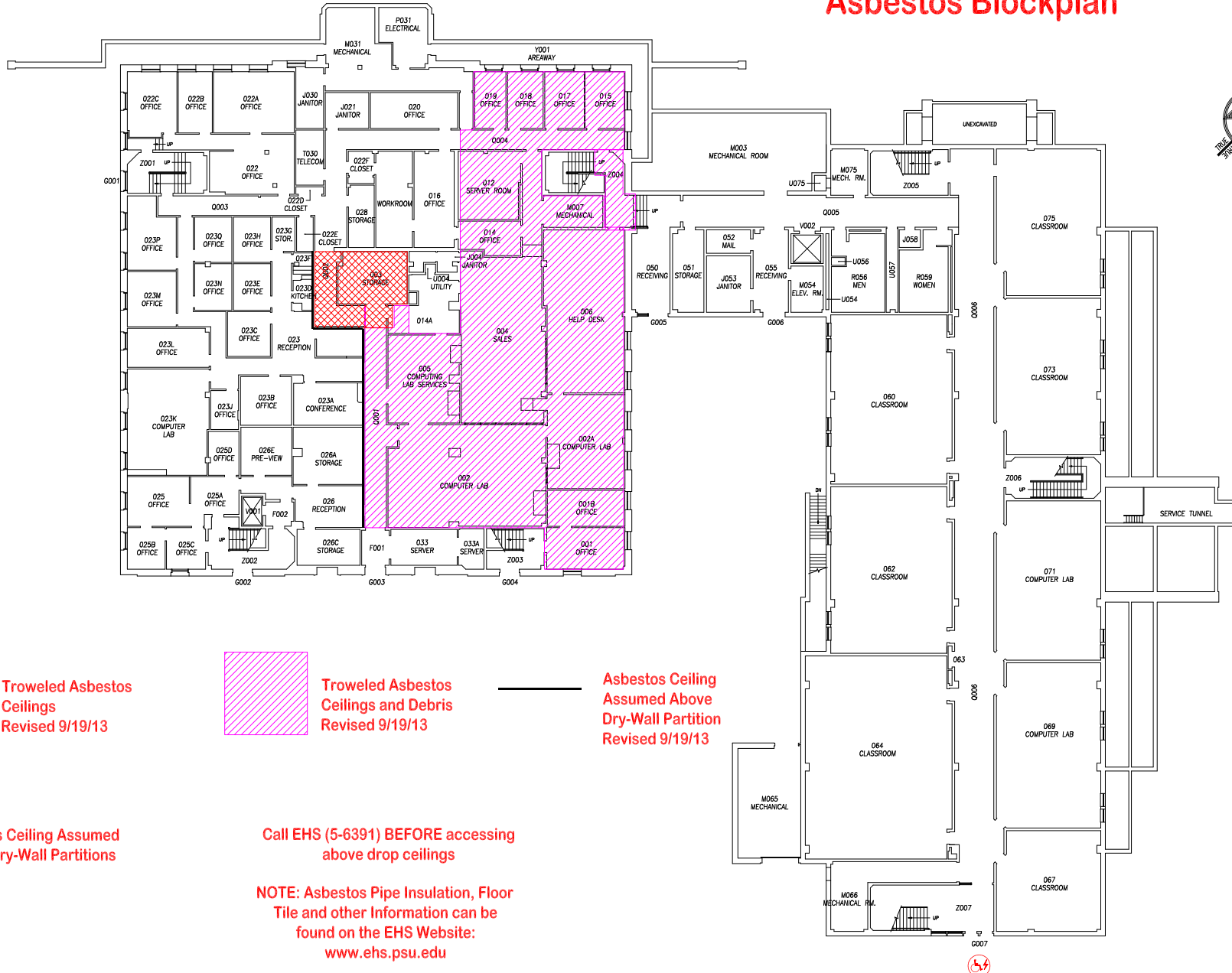

Troweled Asbestos Ceilings Revised 9/19/13



Troweled Asbestos Ceilings and Debris Revised 9/19/13

Asbestos Ceiling Assumed Above Dry-Wall Partition Revised 9/19/13

Asbestos Ceiling Assumed Above Dry-Wall Partitions

Call EHS (5-6391) BEFORE accessing above drop ceilings

NOTE: Asbestos Pipe Insulation, Floor Tile and other Information can be found on the EHS Website: www.ehs.psu.edu

Asbestos Blockplan

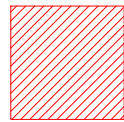

Asbestos Ceiling and Wall Plasters
Revised: 10/06/14

Asbestos Ceiling Assumed
Above Dry-Wall Partitions

Call EHS (5-6391) before accessing
above ceiling tiles

Note: Asbestos Pipe and Floor
Tile Information can be found
on the EHS website at:
www.ehs.psu.edu

WILLARD BUILDING

FIRST FLOOR PLAN

UNIVERSITY PARK CAMPUS, UNIVERSITY PARK, PA

PENNSYLVANIA STATE UNIVERSITY



FACILITIES RESOURCES AND PLANNING

THE PENNSYLVANIA STATE UNIVERSITY
BENEDICT HOUSE
UNIVERSITY PARK, PA 16802
OFFICE: 814.865.1955

FAX: 814.865.1610

www.facilities.psu.edu

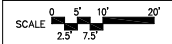

08/29/95 09/28/11

Compass block plans are for referential use only. Drawings are not to be used for architectural or engineering purposes.

0012-000

3 OF 6

1

Asbestos Blockplan



Asbestos Ceiling and Wall Plasters
Revised: 7/23/14

Asbestos Ceiling Assumed
Above Dry-Wall Partitions

Call EHS (5-6391) before accessing
above ceiling tiles

Note: Asbestos Pipe and Floor
Tile Information can be found
on the EHS website at:
www.ehs.psu.edu

WILLARD BUILDING

SECOND FLOOR PLAN

UNIVERSITY PARK CAMPUS, UNIVERSITY PARK, PA

PENNSYLVANIA STATE UNIVERSITY



FACILITIES RESOURCES AND PLANNING

THE PENNSYLVANIA STATE UNIVERSITY
BENEDICT HOUSE
UNIVERSITY PARK, PA 16802
OFFICE: 814.865.1955 FAX: 814.865.1610 www.facilities.psu.edu

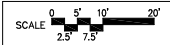

08/29/95 07/18/10

CONTOUR BLOCK PLANS ARE FOR REFERENTIAL USE ONLY. DRAWINGS ARE NOT TO BE USED FOR ARCHITECTURAL OR ENGINEERING PURPOSES.

0012-000

4 OF 6

2

Asbestos Blockplan

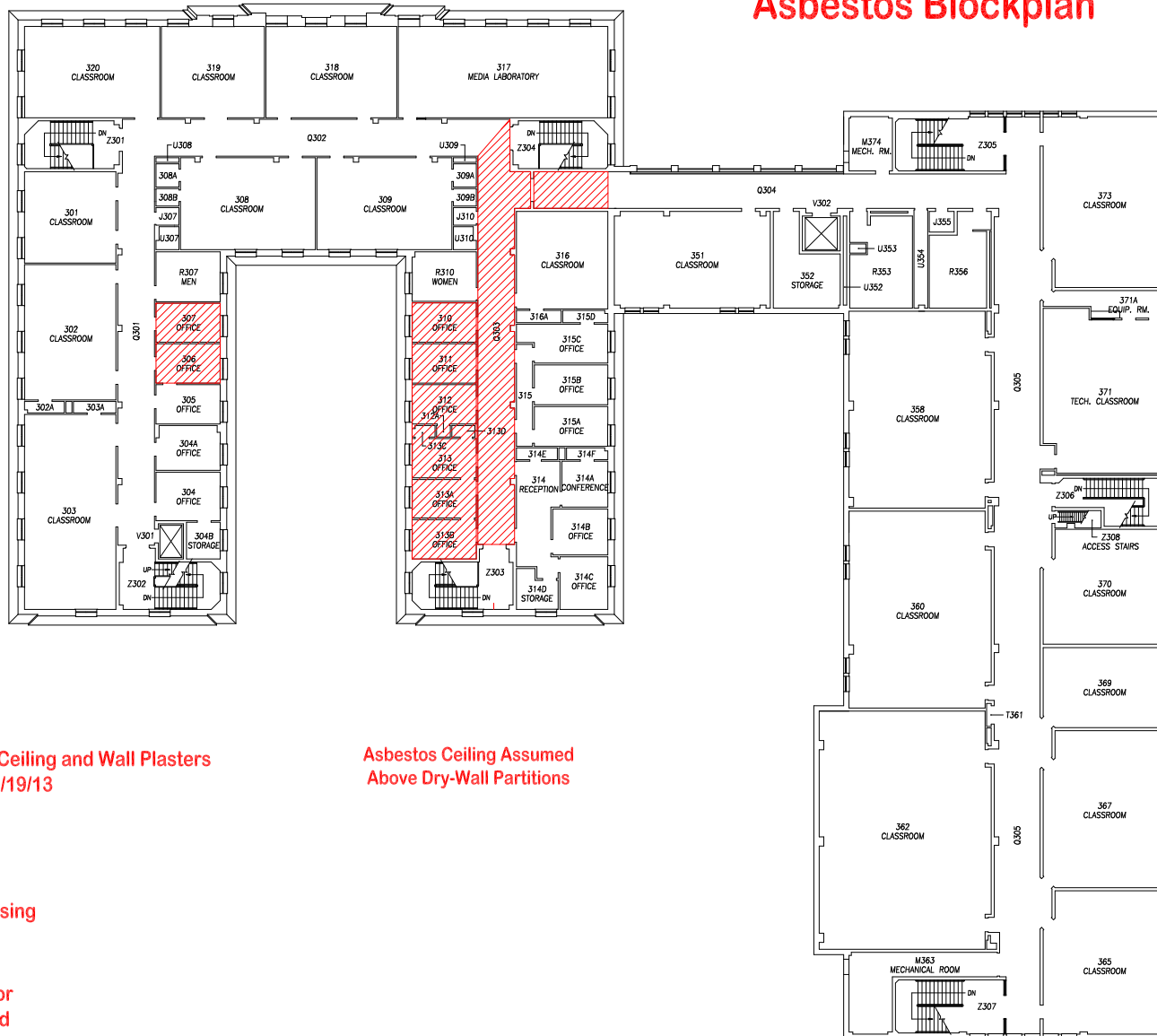

Asbestos Ceiling and Wall Plasters
Revised: 9/19/13

Asbestos Ceiling Assumed
Above Dry-Wall Partitions

Call EHS (5-6391) before accessing
above ceiling tiles

Note: Asbestos Pipe and Floor
Tile Information can be found
on the EHS website at:
www.ehs.psu.edu

WILLARD BUILDING

THIRD FLOOR PLAN
UNIVERSITY PARK CAMPUS, UNIVERSITY PARK, PA

PENNSTATE



FACILITIES RESOURCES AND PLANNING
THE PENNSYLVANIA STATE UNIVERSITY
BENEDICT HOUSE
UNIVERSITY PARK, PA 16802
OFFICE: 814.865.1995 FAX: 814.865.1610 www.facilities.psu.edu

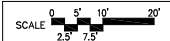

08/29/95 07/23/10

Consent block plans are for informational use only. Drawings are not to be used for architectural or engineering purposes.

0012-000

5 OF 6

3