

# Asbestos Blockplan Rec Hall

**DO NOT PRINT THESE BLOCKPLANS AND ASSUME CHANGES NEVER OCCUR. UPDATES ARE CONSTANTLY BEING ADDED.**

**These blockplans DO NOT include the following asbestos containing materials:**

**Thermal insulations such as pipe, boiler, tank, or duct insulation; these are assumed to contain asbestos unless they are obviously fiberglass or foam rubber.**

**ALL resilient floorings are also assumed to contain asbestos (i.e. 12"x12" and 9"x9" Floor Tile, Linoleum, etc.).**

**ALL Soapstone Lab Bench Tops are also assumed to contain asbestos.**

**Many of these materials are above drop ceilings and are not readily visible. Specific locations of these materials can be obtained by calling Environmental Health and Safety at 5-6391 (3-1111 after 5 P.M.).**

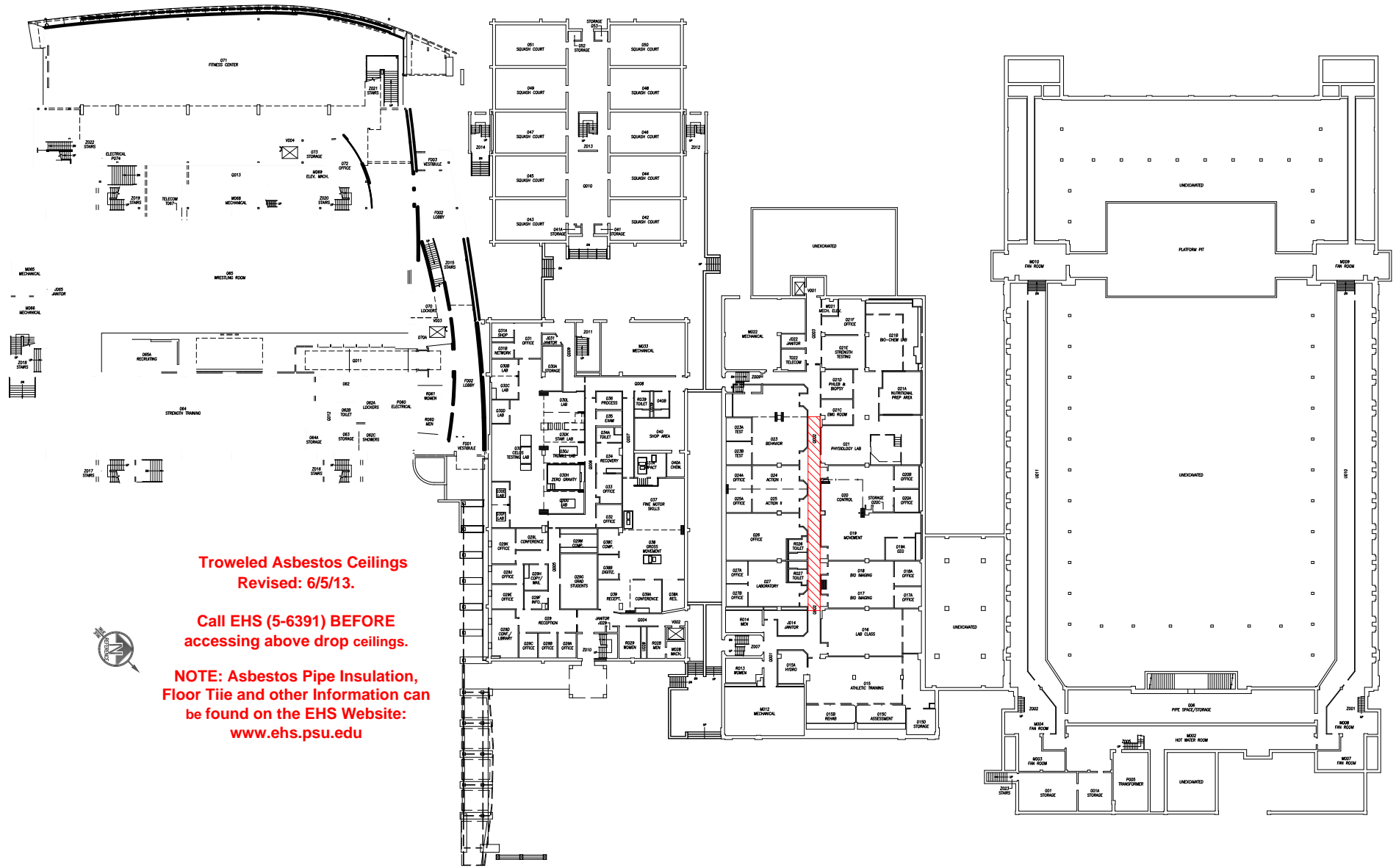

Troweled Asbestos Ceilings  
Revised: 6/5/13.

Call EHS (5-6391) BEFORE  
accessing above drop ceilings.

NOTE: Asbestos Pipe Insulation,  
Floor Tie and other Information can  
be found on the EHS Website:  
[www.ehs.psu.edu](http://www.ehs.psu.edu)



# RECREATION BUILDING (REC HALL)

PSU BUILDING NAME  
**BASEMENT PLAN**  
BUILDING FLOOR LEVEL  
UNIVERSITY PARK CAMPUS, UNIVERSITY PARK, PA  
PSU GROUPS LOCATION

**PENNSTATE**  
FACILITIES RESOURCES AND PLANNING  
THE PENNSYLVANIA STATE UNIVERSITY  
BENEDICT HOUSE  
UNIVERSITY PARK, PA 16802  
OFFICE: 814.865.1595 FAX: 814.865.1610 [www.facilities.psu.edu](http://www.facilities.psu.edu)

SCALE 0 10' 20' 40'  
5' 15'

12/18/05 CREATION DATE 08/31/11 REVISION DATE  
Campus block plans are for referential use only. Drawings are not to be used for architectural or engineering purposes.

0801-000  
BUILDING NUMBER  
1 OF 4  
SHEET NUMBER  
BS  
FLOOR LEVEL

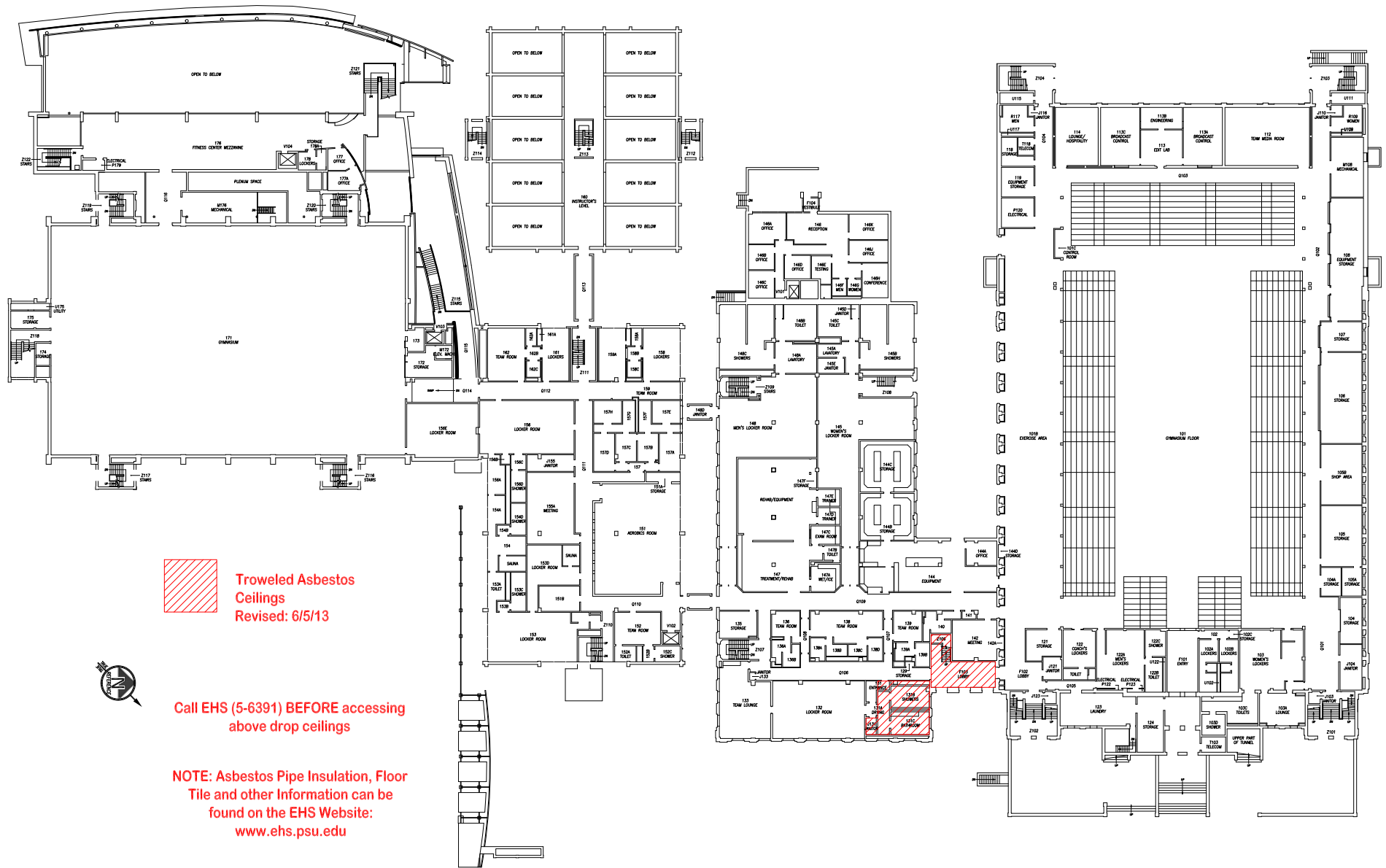

 Troweled Asbestos  
Ceilings  
Revised: 6/5/13



Call EHS (5-6391) BEFORE accessing  
above drop ceilings

NOTE: Asbestos Pipe Insulation, Floor  
Tile and other Information can be  
found on the EHS Website:  
[www.ehs.psu.edu](http://www.ehs.psu.edu)

# RECREATION BUILDING (REC HALL)

080 BUILDING NUMBER  
FIRST FLOOR PLAN  
BUILDING FLOOR LEVEL  
UNIVERSITY PARK CAMPUS, UNIVERSITY PARK, PA  
080 GROUP LOCKERS

**PENNSTATE**



FACILITIES RESOURCES AND PLANNING  
THE PENNSYLVANIA STATE UNIVERSITY  
BENEDICT HOUSE  
UNIVERSITY PARK, PA 16802  
OFFICE: 814.865.1595 FAX: 814.865.1610  
[www.facilities.psu.edu](http://www.facilities.psu.edu)



12/18/08  
CREATED DATE  
04/18/12  
REVISED DATE  
Check this plan out for accuracy and  
changes to be made for  
changes to existing program.

0801-000

BUILDING NUMBER  
2 OF 4  
SHEET NUMBER  
1  
FLOOR LEVEL

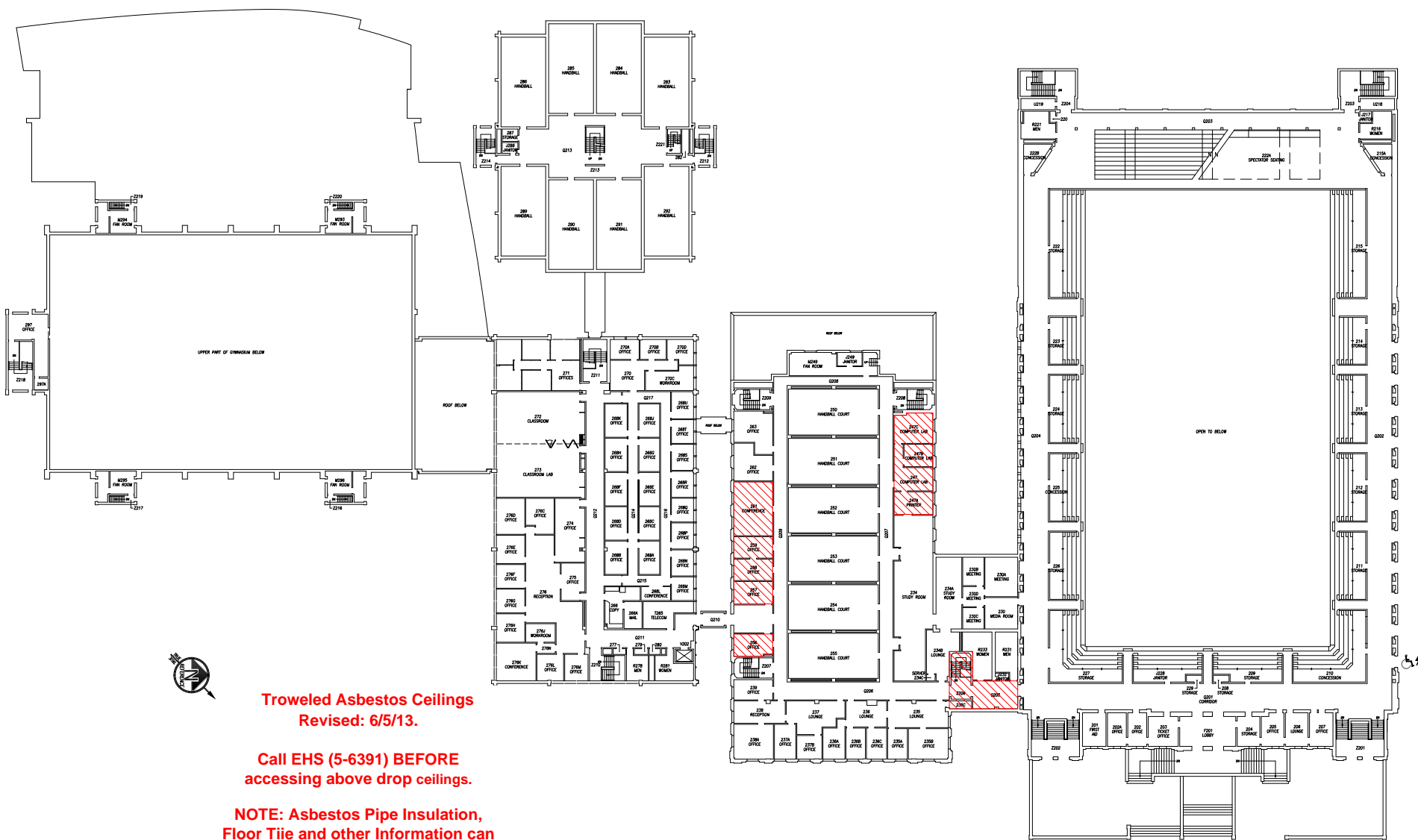

**Troweled Asbestos Ceilings**  
**Revised: 6/5/13.**

**Call EHS (5-6391) BEFORE**  
**accessing above drop ceilings.**

**NOTE: Asbestos Pipe Insulation,**  
**Floor Tile and other Information can**  
**be found on the EHS Website:**  
**[www.ehs.psu.edu](http://www.ehs.psu.edu)**

**RECREATION BUILDING (REC HALL)**

**SECOND FLOOR PLAN**  
 BUILDING FLOOR LEVEL  
 UNIVERSITY PARK CAMPUS, UNIVERSITY PARK, PA  
 FOR CAMPUS LOCATION

**PENNSTATE**  
 FACILITIES RESOURCES AND PLANNING  
 THE PENNSYLVANIA STATE UNIVERSITY  
 BENEDICT HOUSE  
 UNIVERSITY PARK, PA 16802  
 OFFICE: 814.865.1595 FAX: 814.865.1610 [www.facilities.psu.edu](http://www.facilities.psu.edu)

SCALE 0 10' 20' 40'  
 5' 15'

12/18/05 08/31/11  
 ORIGINAL DATE REVISION DATE

Campus block plans are for referential use only. Drawings are not to be used for architectural or engineering purposes.

**0801-000**  
 BUILDING NUMBER

**3 OF 4**  
 SHEET NUMBER

**2**  
 FLOOR LEVEL