

# Asbestos Blockplan Forest Resources Lab

**DO NOT PRINT THESE BLOCKPLANS AND ASSUME CHANGES NEVER OCCUR. UPDATES ARE CONSTANTLY BEING ADDED.**

**These blockplans DO NOT include the following asbestos containing materials:**

**Thermal insulations such as pipe, boiler, tank, or duct insulation; these are assumed to contain asbestos unless they are obviously fiberglass or foam rubber.**

**ALL resilient floorings are also assumed to contain asbestos (i.e. 12"x12" and 9"x9" Floor Tile, Linoleum, etc.).**

**ALL Soapstone Lab Bench Tops are also assumed to contain asbestos.**

**Many of these materials are above drop ceilings and are not readily visible. Specific locations of these materials can be obtained by calling Environmental Health and Safety at 5-6391 (3-1111 after 5 P.M.).**

# Asbestos Blockplan



Call EHS (5-6391) BEFORE accessing above drop ceilings

Note: Asbestos Pipe Insulation, Floor Tile and Other Information can be found on the EHS Website: [www.ehs.psu.edu](http://www.ehs.psu.edu)

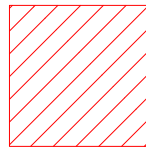

Spray-on Asbestos Ceiling Coating

Revised: 7/19/13

Asbestos Ceiling Assumed Above Dry-Wall Partitions

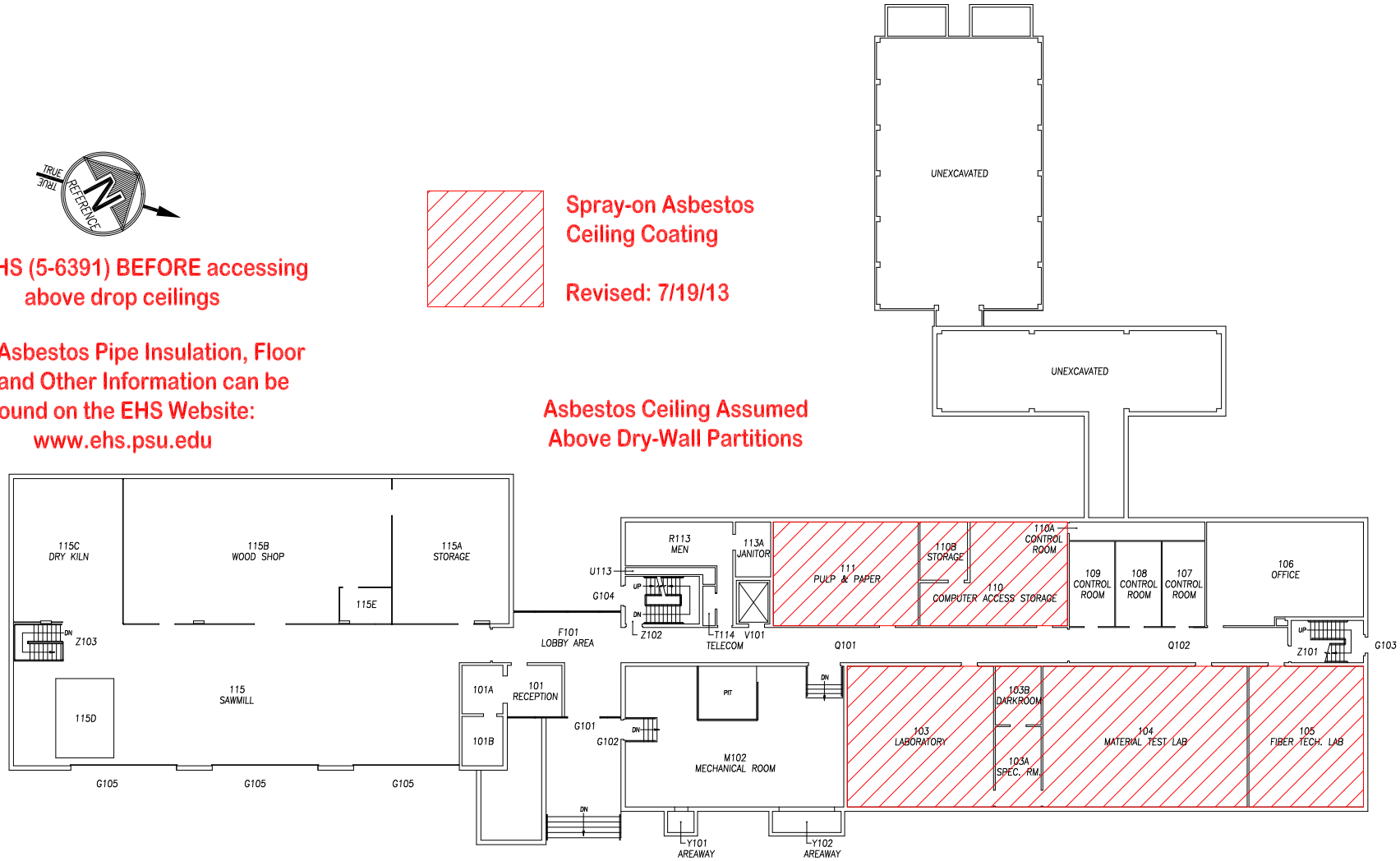

## FOREST RESOURCES LABORATORY

### FIRST FLOOR PLAN

UNIVERSITY PARK CAMPUS, UNIVERSITY PARK, PA

## PENNSTATE



FACILITIES RESOURCES AND PLANNING  
THE PENNSYLVANIA STATE UNIVERSITY  
BENEDICT HOUSE  
UNIVERSITY PARK, PA 16802

OFFICE: 814.865.1595 FAX: 814.865.1610 [www.facilities.psu.edu](http://www.facilities.psu.edu)

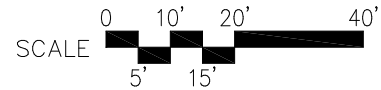

11/17/97

04/18/11

Compass block plans are for referential use only. Drawings are not to be used for architectural engineering purposes.

0111-000

2 OF 4

1

# Asbestos Blockplan



Call EHS (5-6391) BEFORE accessing above drop ceilings

Note: Asbestos Pipe Insulation, Floor Tile and Other Information can be found on the EHS Website: [www.ehs.psu.edu](http://www.ehs.psu.edu)

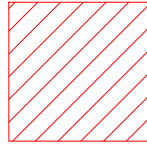

Spray-on Asbestos Ceiling Coating

Revised: 7/19/13

Asbestos Ceiling Assumed Above Dry-Wall Partitions

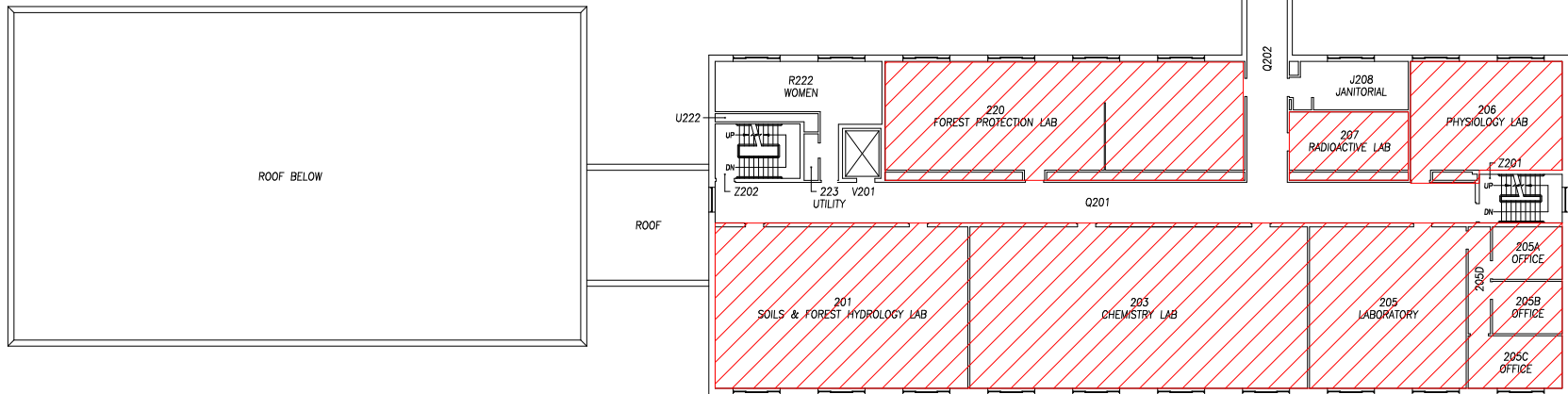

## FOREST RESOURCES LABORATORY

SECOND FLOOR PLAN  
UNIVERSITY PARK CAMPUS, UNIVERSITY PARK, PA

## PENNSTATE



FACILITIES RESOURCES AND PLANNING  
THE PENNSYLVANIA STATE UNIVERSITY  
BENEDICT HOUSE  
UNIVERSITY PARK, PA 16802  
OFFICE: 814.865.1595 FAX: 814.865.1610 [www.facilities.psu.edu](http://www.facilities.psu.edu)

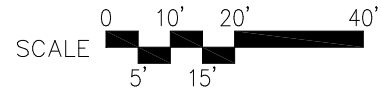

11/17/97  
04/18/11

These block plans are for referential use only. Drawings are not to be used for architectural/engineering purposes.

0111-000

3 OF 4

2

