

Asbestos Blockplans

Electrical Engineering West

DO NOT PRINT THESE BLOCKPLANS AND ASSUME CHANGES NEVER OCCUR. UPDATES ARE CONSTANTLY BEING ADDED.

These blockplans DO NOT include the following asbestos containing materials:

Thermal insulations such as pipe, boiler, tank, or duct insulation; these are assumed to contain asbestos unless they are obviously fiberglass or foam rubber.

ALL resilient floorings are also assumed to contain asbestos (i.e. 12"x12" and 9"x9" Floor Tile, Linoleum, etc.).

ALL Soapstone Lab Bench Tops are also assumed to contain asbestos.

Many of these materials are above drop ceilings and are not readily visible. Specific locations of these materials can be obtained by calling Environmental Health and Safety at 5-6391 (3-1111 after 5 P.M.).

Asbestos Blockplan

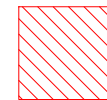
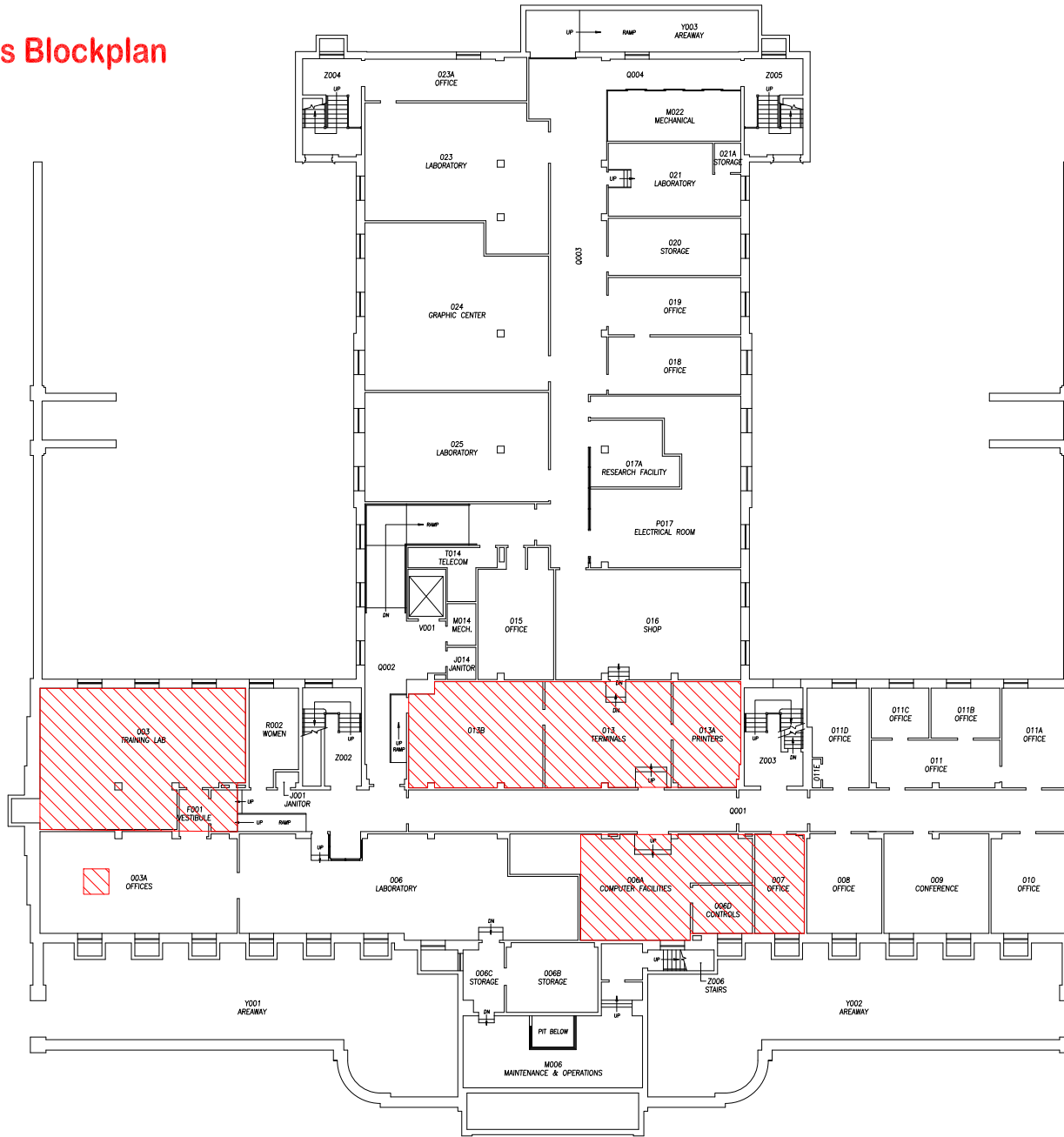

Troweled Asbestos Ceilings
Revised 1/18/13

Asbestos Ceiling Assumed Above Dry-Wall Partitions

Call EHS (5-6391) BEFORE accessing above drop ceilings

NOTE: Asbestos Pipe Insulation, Floor Tile and other Information can be found on the EHS Website: www.ehs.psu.edu

ELECTRICAL ENGINEERING WEST

PSU BUILDING NAME

BASEMENT PLAN

BUILDING FLOOR LEVEL

UNIVERSITY PARK CAMPUS, UNIVERSITY PARK, PA
PSU CAMPUS LOCATION

PENNSTATE



FACILITIES RESOURCES AND PLANNING

THE PENNSYLVANIA STATE UNIVERSITY
BENEDICT HOUSE
UNIVERSITY PARK, PA 16802

OFFICE: 814.865.1595
FAX: 814.865.1610
www.facilities.psu.edu

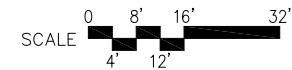

07/01/95
CREATION DATE

10/24/11
REVISION DATE

Campus block plans are for referential use only. Drawings are not to be used for architectural or engineering purposes.

0302-000
BUILDING NUMBER

2 OF 5
SHEET NUMBER

BS
FLOOR LEVEL



Asbestos Blockplan

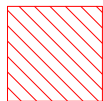

Troweled Asbestos Ceilings
Revised 1/18/13

Asbestos Ceiling Assumed
Above Dry-Wall Partitions

Call EHS (5-6391) BEFORE accessing
above drop ceilings

NOTE: Asbestos Pipe Insulation, Floor
Tile and other Information can be
found on the EHS Website:
www.ehs.psu.edu

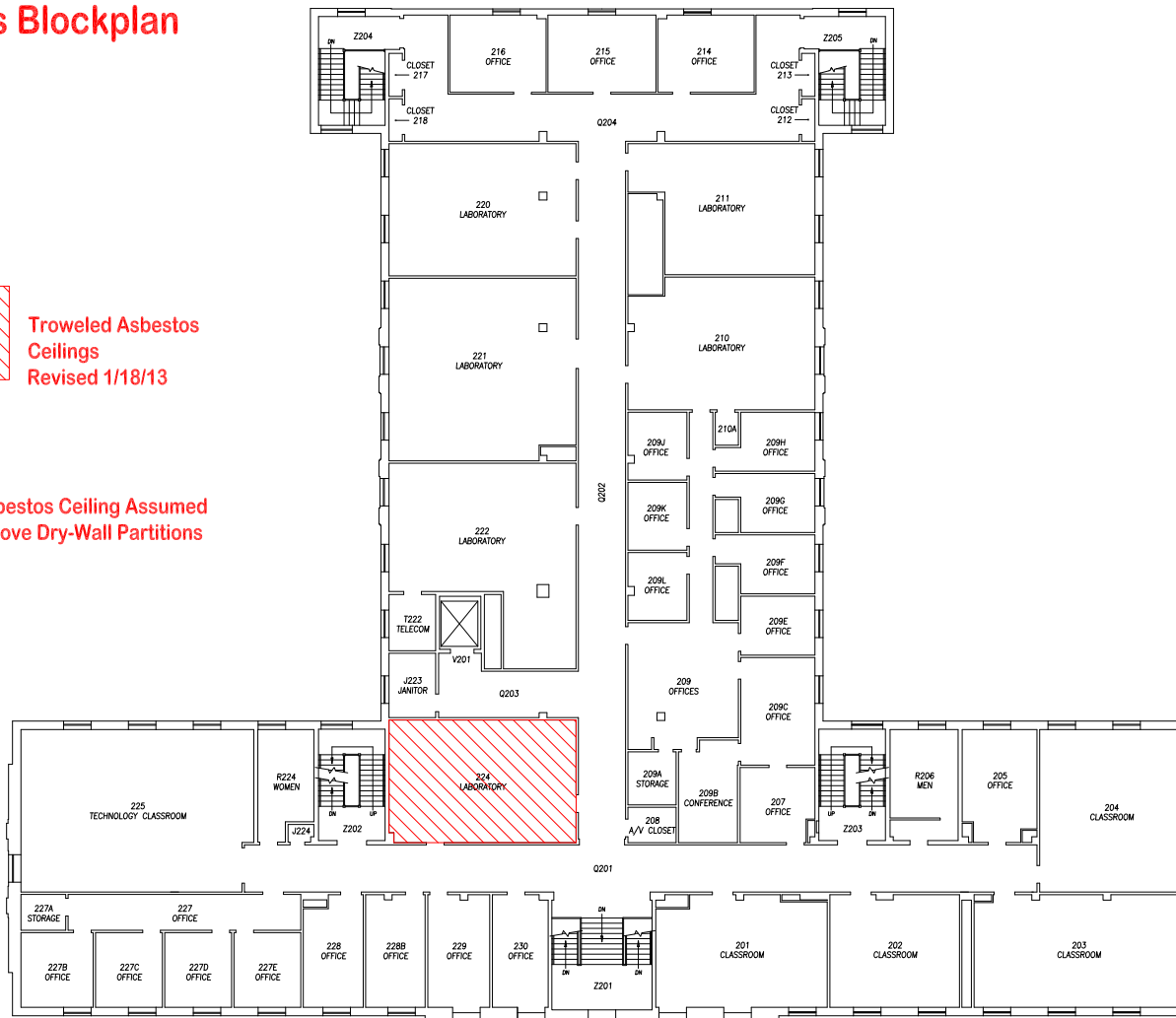

ELECTRICAL ENGINEERING WEST

PSU BUILDING NAME

SECOND FLOOR PLAN

BUILDING FLOOR LEVEL

UNIVERSITY PARK CAMPUS, UNIVERSITY PARK, PA

PSU CAMPUS LOCATION

PENNSTATE



FACILITIES RESOURCES AND PLANNING

THE PENNSYLVANIA STATE UNIVERSITY
BENEDICT HOUSE
UNIVERSITY PARK, PA 16802

OFFICE: 814.865.1595
FAX: 814.865.1610
www.facilities.psu.edu

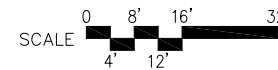

07/01/95
CREATION DATE

10/24/11
REvised DATE

Campus block plans are for referential use only. Drawings
are not to be used for architectural or engineering purposes.

0302-000
BUILDING NUMBER

4 OF 5
SHEET NUMBER

2
FLOOR LEVEL

Asbestos Blockplan

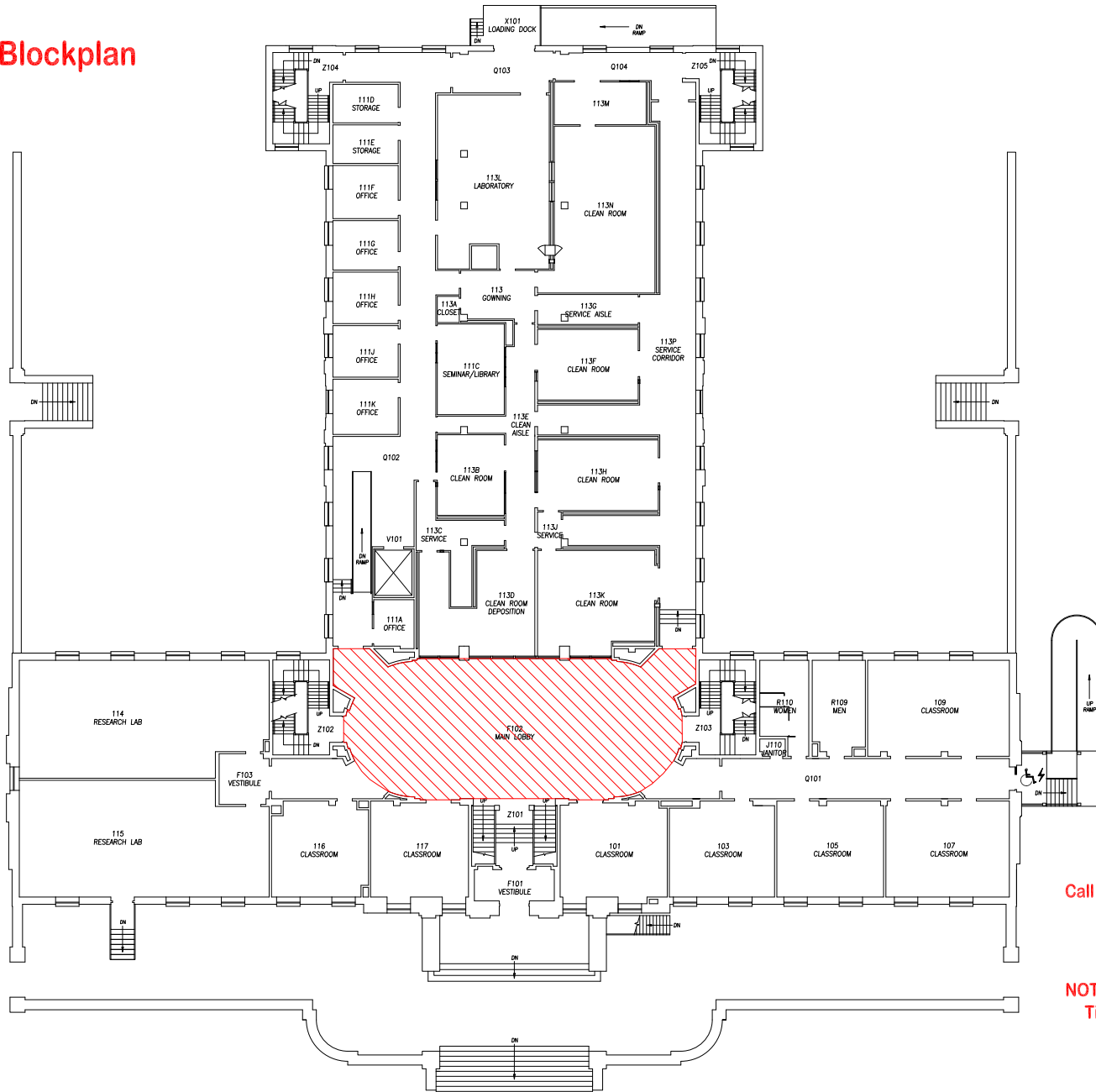

Troweled Asbestos Ceilings
Revised 1/18/13

Asbestos Ceiling Assumed Above Dry-Wall Partitions

Call EHS (5-6391) BEFORE accessing above drop ceilings

NOTE: Asbestos Pipe Insulation, Floor Tile and other Information can be found on the EHS Website: www.ehs.psu.edu

ELECTRICAL ENGINEERING WEST

PSU BUILDING NAME

FIRST FLOOR PLAN

BUILDING FLOOR LEVEL

UNIVERSITY PARK CAMPUS, UNIVERSITY PARK, PA
PSU CAMPUS LOCATION

PENNSTATE



FACILITIES RESOURCES AND PLANNING

THE PENNSYLVANIA STATE UNIVERSITY
BENEDICT HOUSE
UNIVERSITY PARK, PA 16802

OFFICE: 814.865.1595
FAX: 814.865.1610
www.facilities.psu.edu

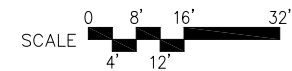

07/01/95
CREATION DATE

10/24/11
REVISION DATE

Campus block plans are for referential use only. Drawings are not to be used for architectural or engineering purposes.

0302-000
BUILDING NUMBER

3 OF 5
SHEET NUMBER

1
FLOOR LEVEL