

Asbestos Blockplan Buckhout Lab

DO NOT PRINT THESE BLOCKPLANS AND ASSUME CHANGES NEVER OCCUR. UPDATES ARE CONSTANTLY BEING ADDED.

These blockplans DO NOT include the following asbestos containing materials:

Thermal insulations such as pipe, boiler, tank, or duct insulation; these are assumed to contain asbestos unless they are obviously fiberglass or foam rubber.

ALL resilient floorings are also assumed to contain asbestos (i.e. 12"x12" and 9"x9" Floor Tile, Linoleum, etc.).

ALL Soapstone Lab Bench Tops are also assumed to contain asbestos.

Many of these materials are above drop ceilings and are not readily visible. Specific locations of these materials can be obtained by calling Environmental Health and Safety at 5-6391 (3-1111 after 5 P.M.).

Asbestos Blockplan

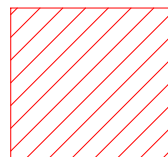
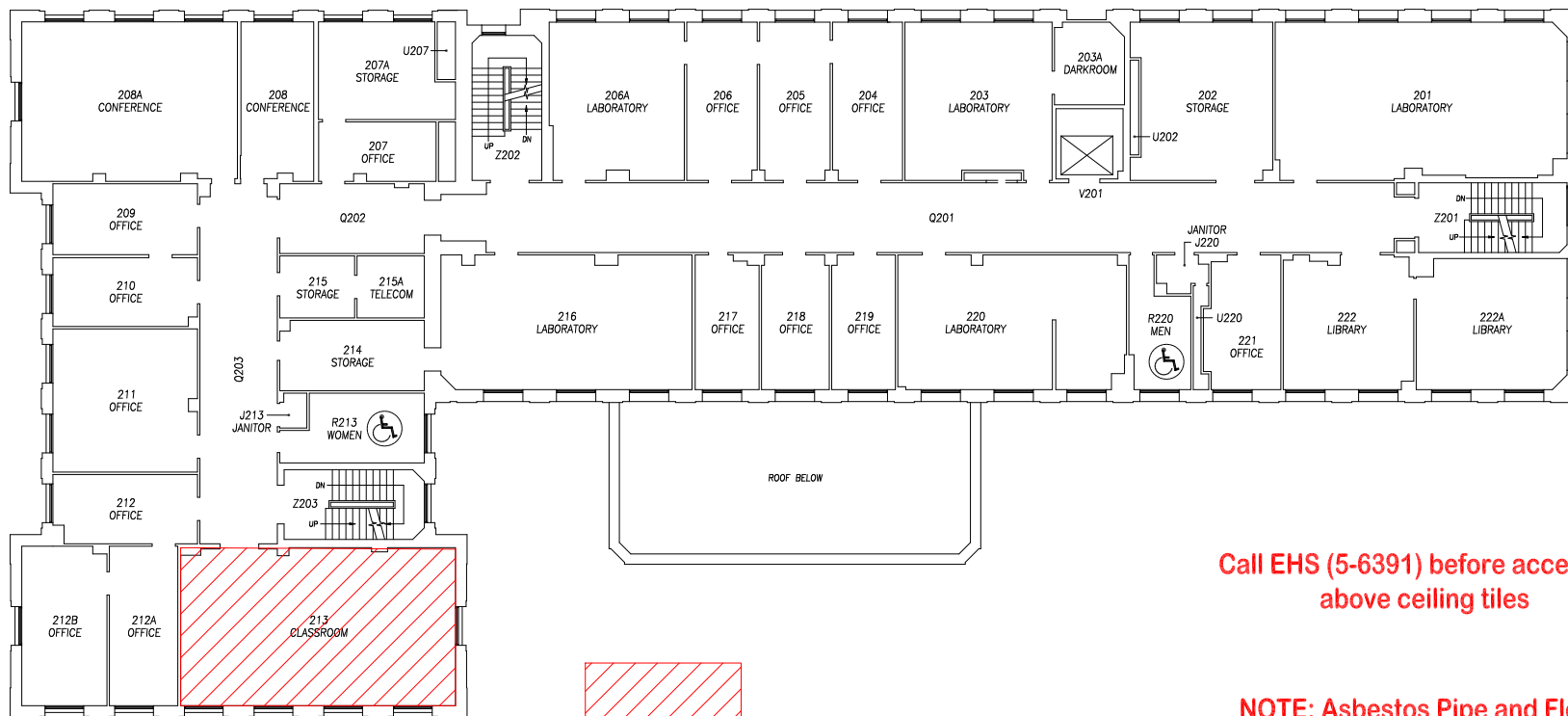
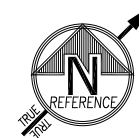

Asbestos Wall Plasters
Revised 5/6/13

**Call EHS (5-6391) before accessing
above ceiling tiles**

**NOTE: Asbestos Pipe and Floor
Tile Information can be found
on the EHS website at:
www.ehs.psu.edu**

BUCKHOUT LABORATORY

SECOND FLOOR PLAN
UNIVERSITY PARK CAMPUS, UNIVERSITY PARK, PA

PENNSTATE



FACILITIES RESOURCES AND PLANNING
THE PENNSYLVANIA STATE UNIVERSITY
BENEDICT HOUSE
UNIVERSITY PARK, PA 16802
OFFICE: 814.865.1595 FAX: 814.865.1610 www.facilities.psu.edu

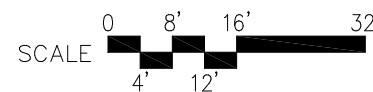

11/30/97
06/07/10

Compass block plans are for
referential use only. Drawings are
not to be used for architectural/
engineering purposes.

0105-000

3 OF 6

2